

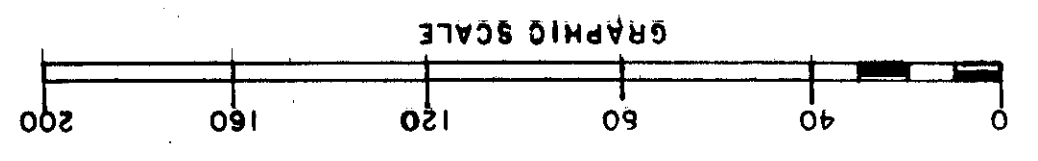

- 12 MUSIC-ART BLDG.
- 11 PESTORAGE
- 10 KINDERGARTEN
- 9 NURSERY
- 8 CLASSROOMS
- 7 PRIMARY CLASSROOMS
- 6 MECH. BLDG.
- 5 CAFETERIA
- 4 ADMIN. & CLASSROOMS
- 3 BLDG.

ADMIN. NO. 0101
PARCEL NO. 010
PARCEL ACREAGE TOTAL 16
TOTAL PARKING SPACES 118



- LEGEND**
- BUILDING NUMBER
 - ROOM NUMBER WITH STUDENT STATIONS
 - ROOM NUMBER
 - ROOM NUMBER SUFFIX TO ADJACENT ROOM
 - ▬ COVERED WALKWAYS
 - ▬ INTERIOR CIRCULATION
 - ▬ PROPERTY LINE
 - X-X- FENCE
 - PROPERTY MARKER

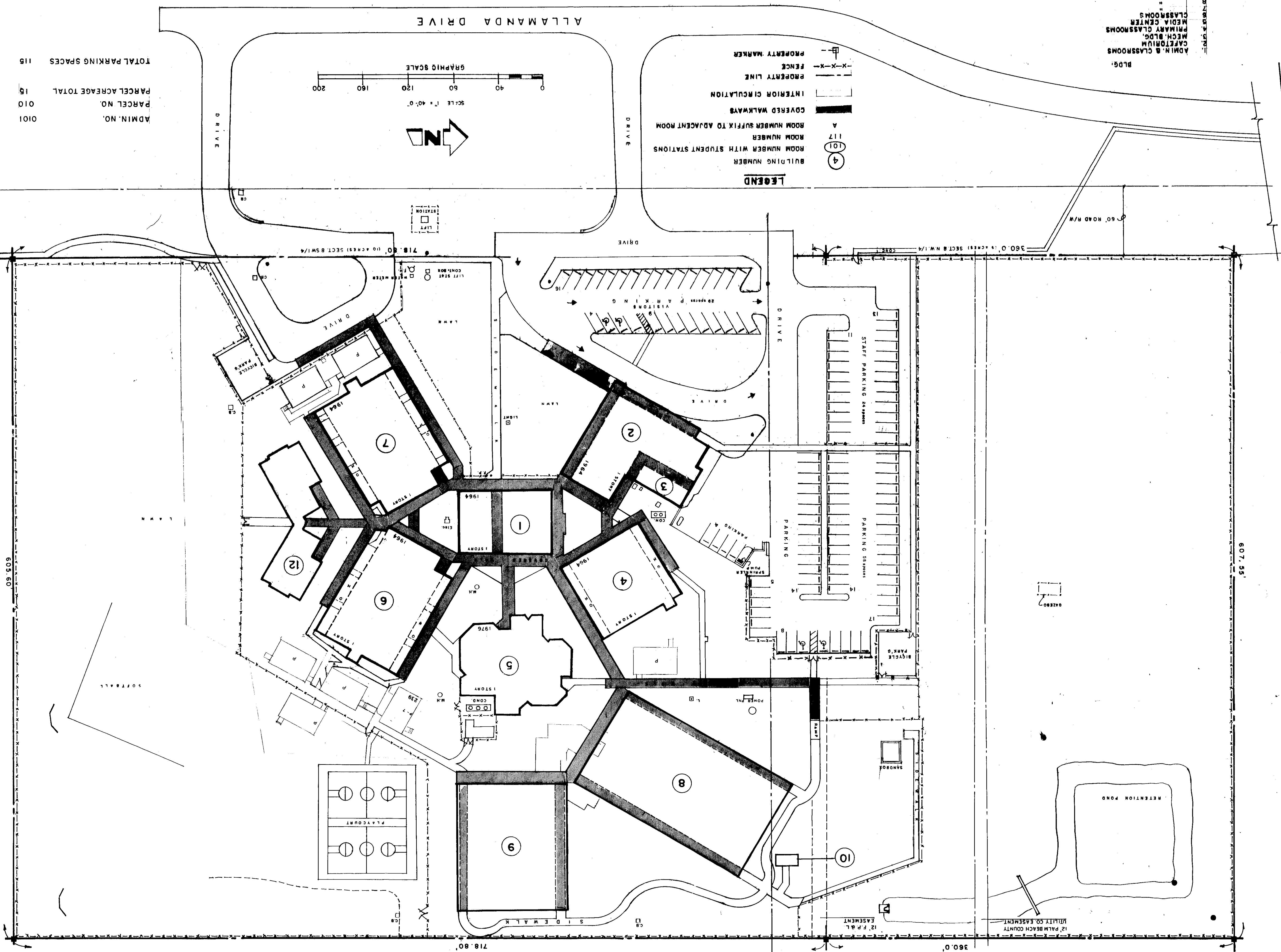
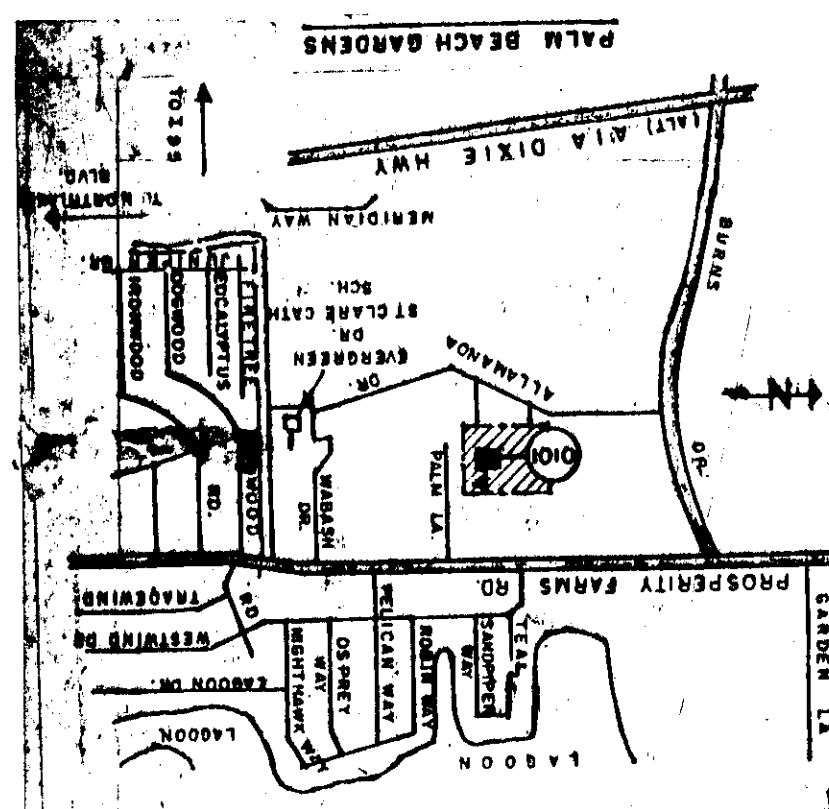

718.80' 360.0' 607.55'